

Stainless Steel Open Body Rigging Screws Hook/Eye

- Material AISI 316.
- Polished finish.

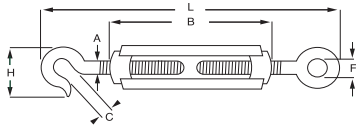

code	A (mm)	B (mm)	L2 (mm)	L1 (mm)	H (mm)	L (mm)	F (mm)	weight (kgs/100)
W0591	5	70	120	52	13	9	8	4
W0592	6	90	160	66	16	10	10	10
W0593	8	120	200	94	20	11	14	17
W0594	9	150	240	120	28	12	16	23
W0595	12	200	300	168	36	14	18	52

Stainless Steel Closed Body Rigging Screws c/w Locknuts - Jaw Jaw

- Material AISI 316.
- Polished finish.

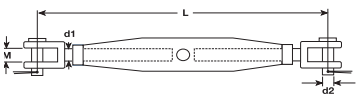

code	d1 (mm)	L (max) (mm)	L (min) (mm)	F (mm)	T (mm)	weight (kgs/100)
W0901	5	190	130	5	7	6.5
W0902	6	210	140	6.5	7	8.1
W0903	8	240	165	8	8	13.9
W0904	10	270	190	9.5	10	25.3
W0905	12	360	245	12.7	14	57.3
W0906	16	450	310	12.7	16	64

NEVER EXCEED MAXIMUM CAPACITY

Ensure operator follows safe use instruction guidelines